

Scott Residence

Los Altos Hills, California



Designed as the first phase of a two-parcel, four-acre estate, the garden occupies a one-acre sloping site. It surrounds an existing wood tract house that was remodeled to serve as the owner's residence while a new main house was constructed on a larger parcel of land; eventually, the small house will be a guest house for the estate. Landscape architects Eldon Beck Associates were asked to create a landscape that would attract wildlife, functioning as a habitat for birds, insects and animals as well as a retreat for humans. Accordingly, meadow and hillside plantings were designed to provide shelter and forage, while a small pool and fountain are home to fish and frogs. The designers carefully positioned decks and terraces to allow for wildlife observation; at the client's request, large shrubs screen the periphery, ensuring privacy.

Paving materials such as random-pattern flagstone walls and walks and decomposed granite drives reflect the project's rustic nature. The designers' extensive use of wildflowers and native grasses not only attracts



wildlife, but also minimizes maintenance and water use. To provide a transition between indoors and out, garden and distant landscape view, Eldon Beck extended a large deck from the living room into the garden. Turf creates a visual transition to the meadow and shrub plantings, which are layered from low-growth perennial varieties at the near side and edges, to tall ornamental grasses closest to the meadow area. The mix of wildlife-resistant and wildlife-attractant plants establishes a long-term habitat that is both nurturing and ornamental.

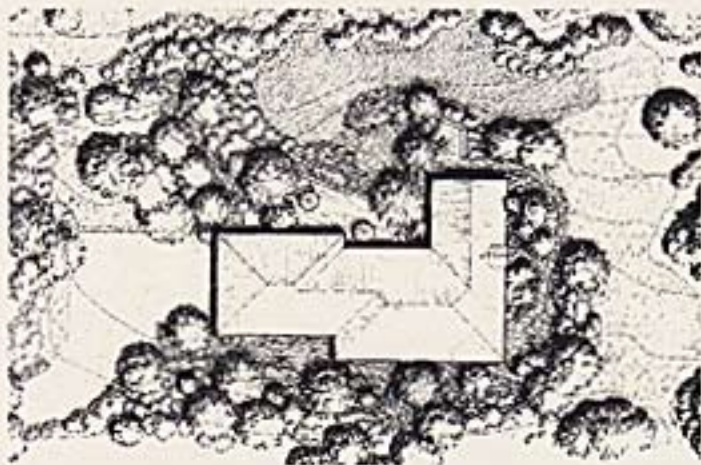

Jury comments

CM: The pond is very nicely detailed.

JVS: The acreage near the house is also nice.

AH: There's a lovely balance of plant materials and hardscape.

Project credits

Landscape architects: Eldon Beck Associates, San Rafael, California

Principal-in-charge: Eldon Beck

Project team: Warren Simmonds (project manager), Steven Perkins, Edward Trapolin

Architect: Stoecker and Northway, Architects, Inc.

Client: Michael Scott

Cost: \$400,000

Left, top and right: Eldon Beck designed a landscape that would attract wildlife as well as appeal to humans; a small pool and hedges provide shelter and food. Above, left: Plan shows transitions from house to garden, garden to estate perimeter via textured plantings and rustic paths.